

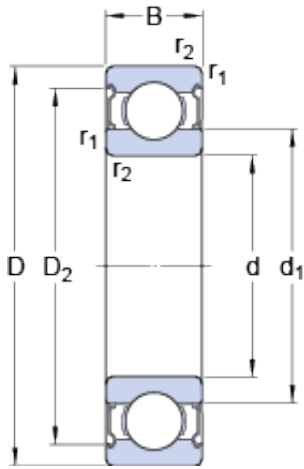

# ROMANIA SNR BEARING Machinery MFG.CORP.



30 mm x 62 mm x 16 mm SKF 6206-2Z/VA201  
deep groove ball bearings

Bearing No. 6206-2Z/VA201

6206-2Z/VA201 Bearing 2D drawings and 3D CAD models

Size	62x30x16 mm
Bore Diameter	62 mm
Outer Diameter	30 mm
Width	16 mm
d	30 mm
D	62 mm
B	16 mm
d <sub>1</sub>	40.36 mm
D <sub>2</sub>	54.06 mm
r <sub>1,2</sub> - min.	1 mm
d <sub>a</sub> - min.	35.6 mm
d <sub>a</sub> - max.	40.3 mm
D <sub>a</sub> - max.	56.4 mm
r <sub>a</sub> - max.	1 mm
Basic dynamic load rating - C	20.3 kN
Basic static load rating - C <sub>0</sub>	11.2 kN
Limiting speed	90 r/min
Limiting temperature - T	250 ° C
Category	Single Row Ball Bearings
Inventory	0.0
Manufacturer Name	SKF
Minimum Buy Quantity	N/A
Weight / Kilogram	0.216
EAN	7316577740977



## ROMANIA SNR BEARING Machinery MFG.CORP.

Product Group	B00308
Enclosure	2 Metal Shields
Precision Class	ABEC 1   ISO P0
Maximum Capacity / Filling Slot	No
Rolling Element	Ball Bearing
Snap Ring	No
Internal Special Features	Polyalkylene Glycol/Graphite Mixture Filled
Cage Material	Steel
Internal Clearance	C0-Medium
Inch - Metric	Metric
Long Description	30MM Bore; 62MM Outside Diameter; 16MM Outer Race Width; 2 Metal Shields; Ball Bearing; ABEC 1   ISO P0; No Filling Slot; No Snap Ring; Polyalkylene Glycol/Graphite Mixture Filled Internal Special Fea
Other Features	Deep Groove   Extreme Temperature Variant
Category	Single Row Ball Bearing
UNSPSC	31171504
Harmonized Tariff Code	8482.10.50.68
Noun	Bearing
Keyword String	Ball
Manufacturer URL	<a href="http://www.skf.com">http://www.skf.com</a>
Manufacturer Item Number	6206-2Z/VA201
Weight / LBS	0.439
Inner Race Width	0 Inch   0 Millimeter
Outer Race Width	0.63 Inch   16 Millimeter
Outside Diameter	2.441 Inch   62 Millimeter
Bore	1.181 Inch   30 Millimeter
bore diameter:	30 mm



## ROMANIA SNR BEARING Machinery MFG.CORP.

precision rating:	Not Rated
outside diameter:	62 mm
finish/coating:	Uncoated
overall width:	16 mm
cage material:	Steel
bore type:	Round
outer ring width:	16 mm
closure type:	Double Shielded
fillet radius:	1 mm
row type & fill slot:	Single Row Non-Fill Slot
maximum rpm:	190 RPM
internal clearance:	C0
series:	62
operating temperature range:	-20 to +480 ° F
resistance features:	Corrosion Resistant, Extreme Temperature
static load capacity:	11.2 kN
$d_1$	40.36 mm
$D_2$	54.06 mm
$r_{1,2}$ min.	1 mm
$d_a$ min.	35.6 mm
$d_a$ max.	40.3 mm
$D_a$ max.	56.4 mm
$r_a$ max.	1 mm
Basic dynamic load rating C	20.3 kN
Basic static load rating $C_0$	11.2 kN
Limiting temperature T max.	250 ° C
Mass bearing	0.21 kg